

# AWARDS

INTERIOR DESIGN EXCELLENCE

**IIDA**

VIRGINIA  
WEST VIRGINIA  
chapter

**2025**

AMERICAN  
SOCIETY OF  
INTERIOR  
DESIGNERS  
VIRGINIA



# PRODUCTION COMMITTEE



**Allison Usry**

Haworth



**Susan Pniewski**

Christopher West Interiors



**Mary Katherine Crouch**

Image Business Interiors



**Danica Bocchicchio**

Image Business Interiors



**Terry Umberger**

Cherry Carpet



**Paige Conrad**

Hanbury



**Hannah Jones**

PF&A



**Christie Thompson**

Campfire & Co.



**Austin Fitzgerald**

Freshman Studio



# 2025 PROGRAM SPONSORS



**Dan Lurie**  
Associates, Inc.  
Architectural and Interior Products



**creative  
materials  
corporation**

**Kovet**  
The Art of Seating



**Ohio Valley Supply**  
Quality Building Materials Since 1949



**Interface®**



# 2025 STUDENT SPONSORS

**New Day Office Products & Furnishings** | Matt Brady (13)

**CF Stinson** | Tim Stone (3)

**Mosaic Tile** | Jen Reeves (3)

**SitOnIt** | Brandi Allen (2)

**GovSolutions** | Donna Long (2)

**Kimball** | Salina Traynham (1)

**Workplace Solutions** | Maryann Woods (1)

**Humanscale** | Toni Eubanks (1)

**Patcraft** | Allison Copley (1)

# AWARDS

INTERIOR DESIGN EXCELLENCE

**IIDA**

VIRGINIA  
WEST VIRGINIA  
chapter

**2025**

AMERICAN  
SOCIETY OF  
INTERIOR  
DESIGNERS  
VIRGINIA





STUDENT CATEGORY













**HAYLEY WALKER,  
BARRICK MOGEL  
& ABBY SIKORA**  
RADFORD, CLASS OF 2025

HONORABLE MENTION

# Radiant Renewal Women's Oncology Center

STUDENT CATEGORY

















**PIA JADE FUENTES**  
VIRGINIA TECH, CLASS OF 2026

HONORABLE MENTION

# The Canopy Library

STUDENT CATEGORY













**ANNA GOODMAN**  
VIRGINIA TECH, CLASS OF 2025

FIRST PLACE

The Place

STUDENT CATEGORY





















EMILY MINNIX  
VCU, CLASS OF 2025

FIRST PLACE

Patchworks

STUDENT CATEGORY







RESIDENCE  
UNDER 3,500 SF



















# CIRCLE DESIGN STUDIO

Theresa Dorlini & John Dorlini

FIRST PLACE

## Farley Lakehouse

RESIDENCE UNDER 3,500 SF





RESIDENCE  
OVER 3,500 SF





















## PILLAR & PEACOCK

Adrienne Bugg, Brandeis Short  
& Pamela Horst

HONORABLE MENTION

Camp

RESIDENCE OVER 3,500 SF



















**PILLAR & PEACOCK**

Adrianne Bugg & Brandeis Short

HONORABLE MENTION

# Boho Hideaway in the Heart of The Fan

RESIDENCE OVER 3,500 SF























## GARY INMAN INTERIORS

Gary Inman, Dani Blake & Maddie Potter

FIRST PLACE

# Mid-Century Mansion

RESIDENCE OVER 3,500 SF























**SMBW, PLLC**

Melinda Jeffries & Spencer Grice

FIRST PLACE

# Lake House

RESIDENCE OVER 3,500 SF





















# CIRCLE DESIGN STUDIO

Theresa Dorlini & John Dorlini

FIRST PLACE

## Private Lakehouse B

RESIDENCE OVER 3,500 SF





SINGULAR SPACE

















**CIRCLE DESIGN STUDIO**

Theresa Dorlini & Brittany Newman

HONORABLE MENTION

**Imre Residence**

SINGULAR SPACE



















## PILLAR & PEACOCK

Adrienne Bugg, Brandeis Short  
& Pamela Horst

HONORABLE MENTION

# A Tale of Refinement: Transforming a Dutch Colonial

SINGULAR SPACE

















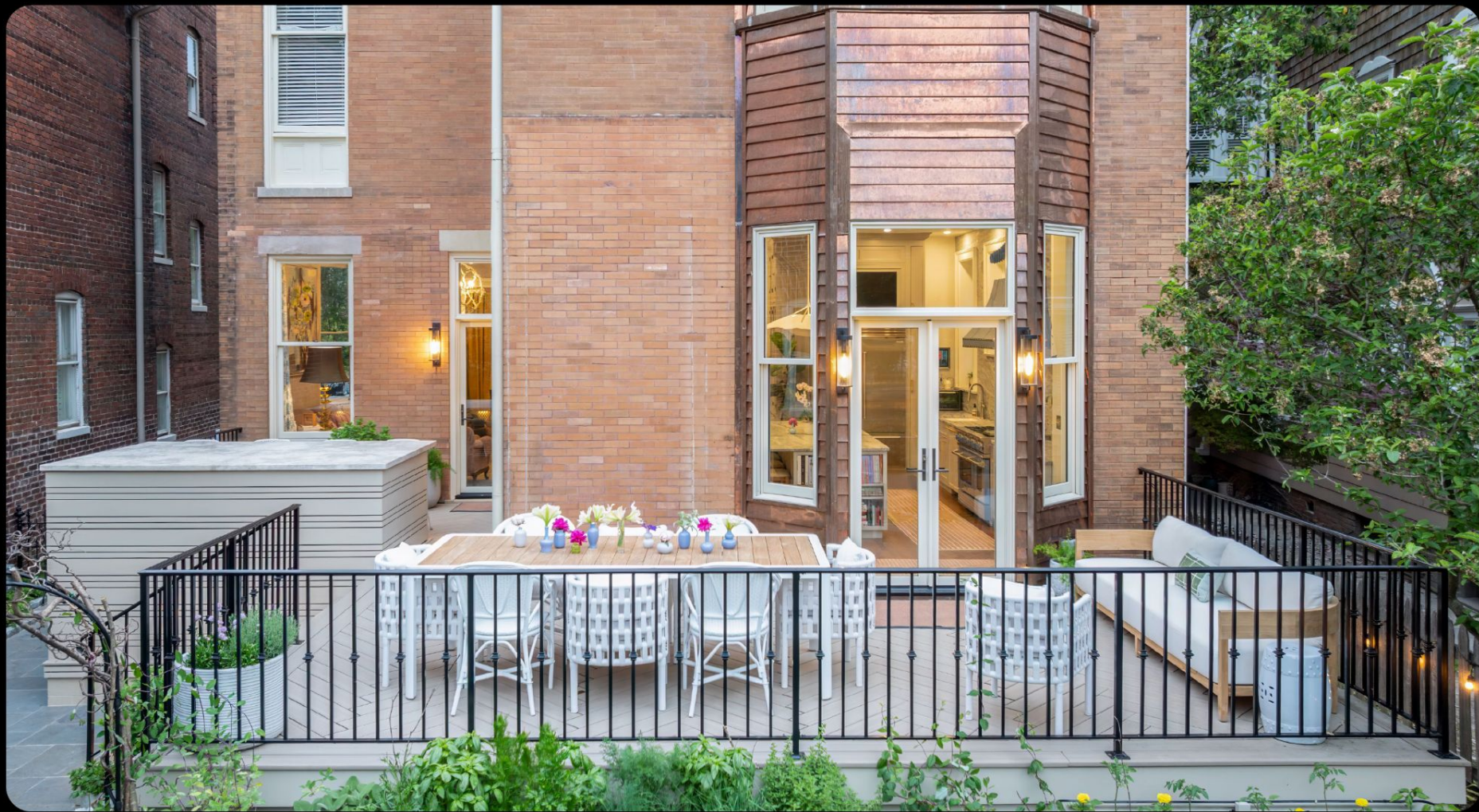



**GARC LLC**

Yang Tian & Suping Li

FIRST PLACE

# Historic Kitchen Transformation

SINGULAR SPACE







# CORPORATE UNDER 35,000 SF

SPONSORED BY  
LIGHTING ENVIROMENTS



















## SMBW, PLLC

Michelle Mikita, Andy Lehman,  
Kelsey Levitt & Jesse Stallard

HONORABLE MENTION

# Global Investment Bank Firm

CORPORATE UNDER 35,000 SF



















## CBT WITH BASKERVILL

CBT : Jan Abercrombie, Jennifer Celli,  
Luke Tanguay, Lois Goodell, Alanna  
Masciarelli | BASKERVILL : Gillian Bowman,  
Kaitey Crouse

HONORABLE MENTION

# VHB Two James Center Relocation

CORPORATE UNDER 35,000 SF





SCHOOLEY LAW FIRM

















**FULTZ & SINGH  
ARCHITECTS**

Josie Price

HONORABLE MENTION

**Schooley Law**

CORPORATE UNDER 35,000 SF





















## HANBURY

Paige Conrad, Meredith Lewis  
& Anne Bradley

FIRST PLACE

sPARK AXIS

CORPORATE UNDER 35,000 SF

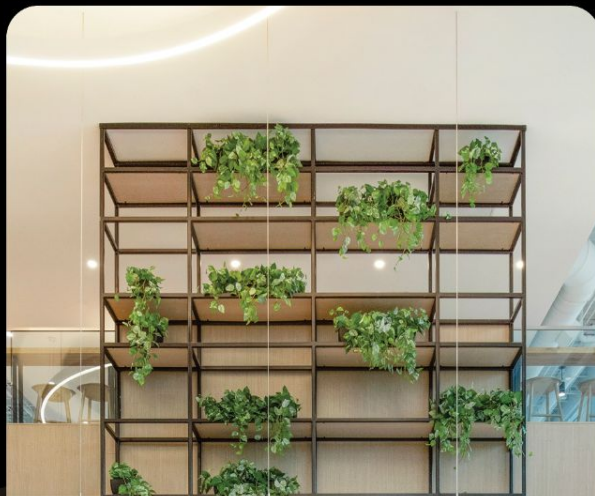

















**CAMPFIRE & CO.**

Rachel Howlett & Avery Fox

FIRST PLACE

# West Cary Group Office

CORPORATE UNDER 35,000 SF



















## CAMPFIRE & CO.

Rachel Howlett, Avery Fox & Christina Kern

FIRST PLACE

# Tilt Creative + Production Office

CORPORATE UNDER 35,000 SF





HEALTHCARE  
UNDER 15,000 SF





PHARMACY













**INNOVATE ARCHITECTURE  
& INTERIORS**

Britney Webb

HONORABLE MENTION

**LGBT Life Center:  
Hampton**

HEALTHCARE UNDER 15,000 SF



















**PF&A DESIGN**

Hannah Jones & Autumn Orick

FIRST PLACE

# Lake Taylor Pediatric Renovation

HEALTHCARE UNDER 15,000 SF







# HOSPITALITY

SPONSORED BY  
KOVET HOSPITALITY



eazzv burger

3204

R GARDEN















**FULTZ & SINGH  
ARCHITECTS**

James Hill

HONORABLE MENTION

**Eazzy Burger**

HOSPITALITY





















**STUDIO BROAD**

Heather Hopkins & Pnina Jalon

HONORABLE MENTION

The Junction

HOSPITALITY

























**GLAVE & HOLMES  
ARCHITECTURE**

Leah Stoner, Daniel Murrow  
& Jessica Ritter

FIRST PLACE

**Villaggio  
Ristorante  
Renovation**

HOSPITALITY



















**GLAVE & HOLMES  
ARCHITECTURE**

Vanessa Smith, Leah White  
& Jessica Ritter

FIRST PLACE

**Hotel Roanoke  
Guest Rooms**

HOSPITALITY



The background features a dark gray field with four large, light gray geometric shapes: a vertical rectangle on the left, a rounded rectangle in the center-left, a vertical rectangle in the center-right, and a triangle on the right. The text 'EDUCATIONAL (K-12)' is centered horizontally across the middle of these shapes.

EDUCATIONAL (K-12)





















**GLAVE & HOLMES  
ARCHITECTURE**

Sam Weiss, Mary Katherine Crouch  
& Jessica Ritter

HONORABLE MENTION

**Saint Gertrude  
High School**

EDUCATIONAL (K-12)







# HIGHER EDUCATION

SPONSORED BY  
CREATIVE MATERIALS  
CORPORATION

















**CLARK NEXSEN**

Melanie Dover Goodson  
& Susan Drew

HONORABLE MENTION

# University of Virginia Wyllie Hall Repurpose

HIGHER EDUCATION



# *School of* EDUCATION

















**WORK PROGRAM  
ARCHITECTS**

Alison Allred, Benjamin Sturkie  
& Ryan Fremeau

HONORABLE MENTION

Norfolk State  
University:  
Herman H.  
Bozeman Hall  
Renovation

HIGHER EDUCATION



















**HANBURY**  
Matthew Lee

FIRST PLACE

# Clemson University: Brook T. Smith Launchpad

HIGHER EDUCATION

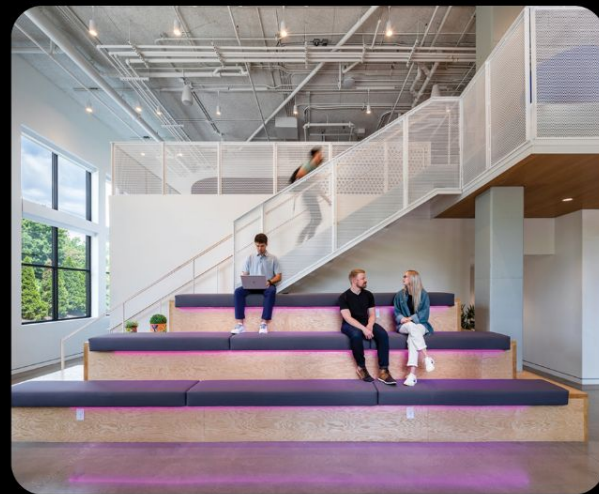

The background is a solid dark gray. Overlaid on this are four large, light gray geometric shapes: a vertical rectangle on the left, a rounded rectangle in the center-left, a vertical rectangle in the center-right, and a triangle on the right. The text 'HISTORIC PRESERVATION' is centered over the rounded rectangle and the central vertical rectangle.

# HISTORIC PRESERVATION

















**GLAVE & HOLMES  
ARCHITECTURE**

Bridget Ficaretta, Isolde Wiles  
& Jessica Ritter

HONORABLE MENTION

Reid's Row  
Rehabilitation

HISTORIC PRESERVATION





















**GLAVE & HOLMES  
ARCHITECTURE**

Sam Weiss, Veronica Ledford  
& Jessica Ritter

HONORABLE MENTION

**VMI 412 Parade  
Rehabilitation**

HISTORIC PRESERVATION





The letters 'IDA' are rendered in large, dark gray, stylized shapes. The 'I' is a simple vertical rectangle. The 'D' is a rounded rectangle with a semi-circular cutout on its right side. The 'A' is a triangle with rounded corners and a small semi-circular notch at its top apex.

GOVERNMENT













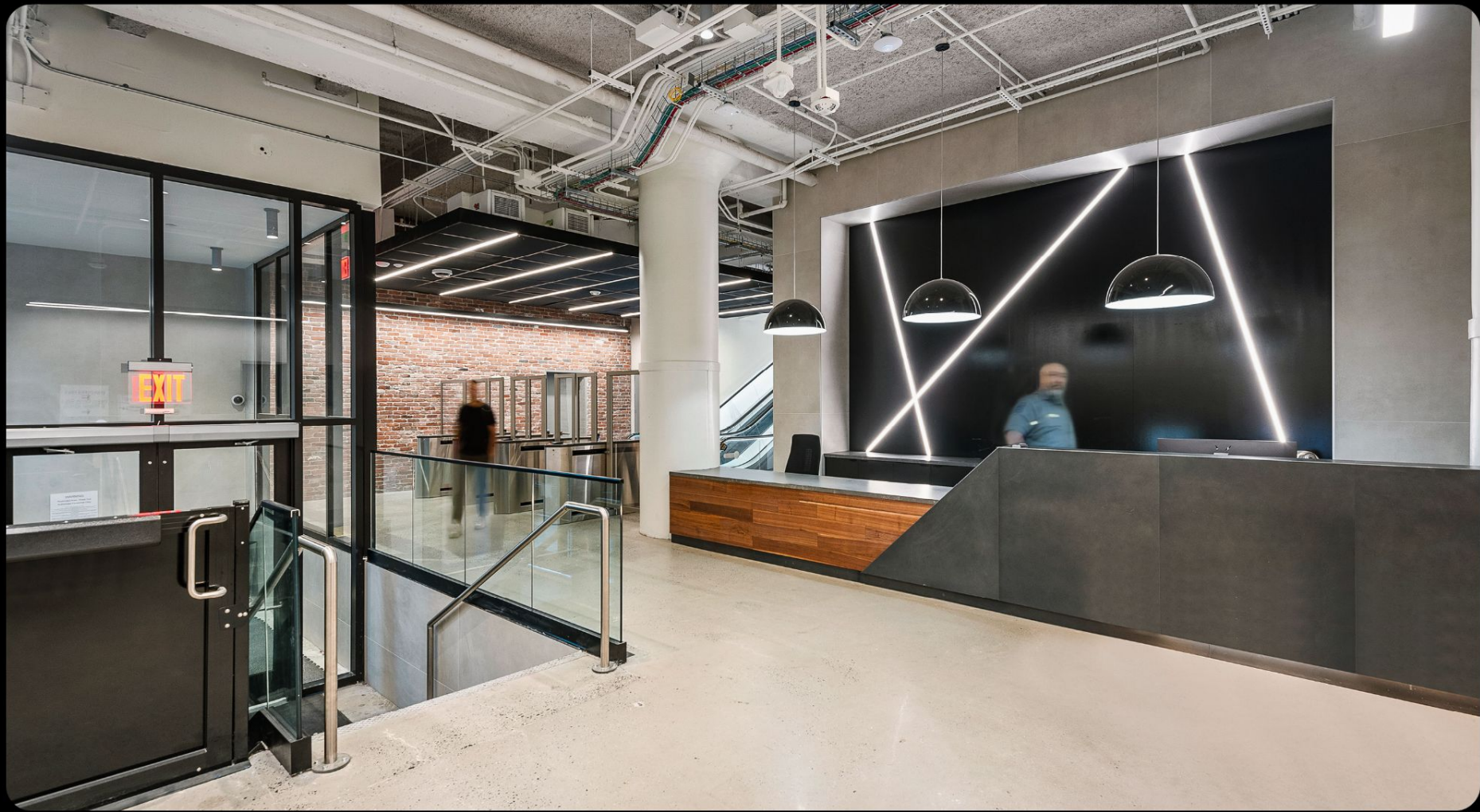







AECOM

HONORABLE MENTION

CONFIDENTIAL  
FEDERAL  
CLIENT

GOVERNMENT



The letters 'IDWA' are represented by large, dark gray geometric shapes. The 'I' is a simple vertical rectangle. The 'D' is a rounded rectangle with a semi-circular end on the right. The 'W' is a rectangle with rounded corners. The 'A' is a triangle with rounded corners and a small semi-circular notch at the top. The word 'RETAIL' is written in a yellow, sans-serif font, centered horizontally and partially overlapping the 'D' and 'W' shapes.

RETAIL





















**CAMPFIRE & CO.**

Lauren Stewart & Avery Fox

HONORABLE MENTION

**Sugar & Twine**

RETAIL

























# 510 ARCHITECTS

Rachel Ramey & Juliana Allen

FIRST PLACE

## Yellow Umbrella

RETAIL





The image features the letters 'IDWA' in a large, dark gray, sans-serif font. The 'I' is a simple vertical bar. The 'D' is composed of a vertical bar and a semi-circle on its right side. The 'W' is formed by two 'V' shapes joined at their bases. The 'A' is a simple triangle. The word 'CUSTOM' is written in a smaller, yellow, sans-serif font, centered horizontally and overlapping the 'D' and 'W' of the 'IDWA' letters.

CUSTOM

















## HANBURY

Katrina Van Orden, Natsumi Oba,  
Perry Hammond, Ryan Lewandowski  
& An Liu

FIRST PLACE

# CASA Playhouse: Enchanted Tree

CUSTOM





INSTITUTIONAL







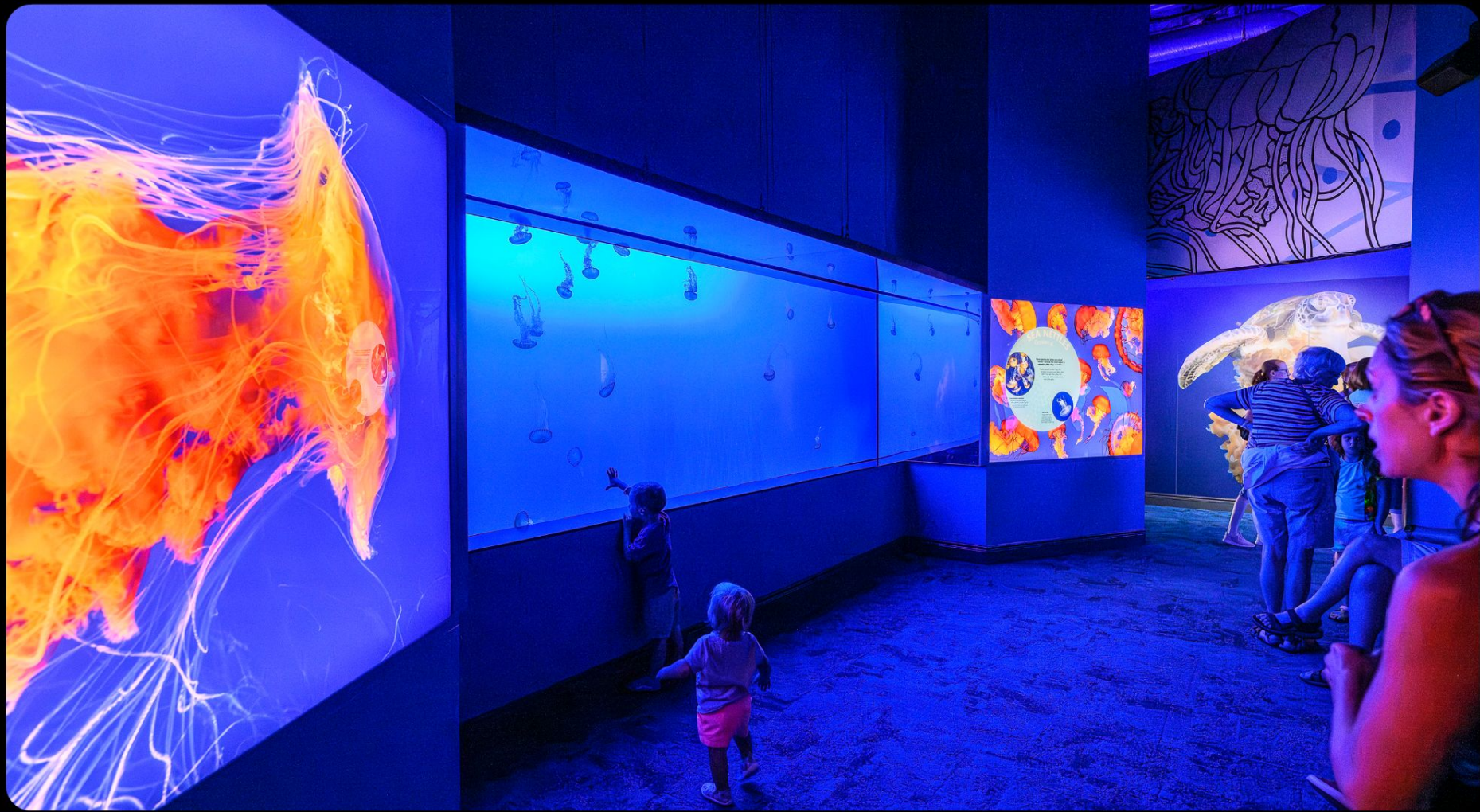







# JELLIES

SIMPLE SURVIVAL

Jellies









**WOOLPERT**

Kristi Barker

HONORABLE MENTION

# Virginia Aquarium & Marine Science Center: South Building Renovation & Expansion

INSTITUTIONAL





















**HANBURY**

Paige Conrad & Anne Bradley

HONORABLE MENTION

# sPARK Fitness Center

INSTITUTIONAL





















**CIRCLE DESIGN STUDIO**

Theresa Dorlini & John Dorlini

HONORABLE MENTION

New Hope Church

INSTITUTIONAL









# LIBRARY



YM

Hanover  
County









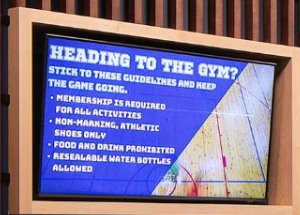

GYM

Hanover  
County

**MOSELEY (FORMERLY  
MOSELEY ARCHITECTS)**

Elena Boyle

FIRST PLACE

# Hanover County Montpelier Park Community Center Library

INSTITUTIONAL























**HBA ARCHITECTURE +  
INTERIOR DESIGN, INC**

Joseph A. Miller & Chris Ames

FIRST PLACE

**Midlothian  
Library**

INSTITUTIONAL





The background is a solid dark gray. Overlaid on this are four large, semi-transparent geometric shapes: a vertical rectangle on the left, a rounded rectangle in the center-left, a rounded rectangle in the center-right, and a triangle on the right. The text is centered over the intersection of the two central rounded rectangles.

CERTIFIED  
SUSTAINABLE  
BUILDING

















**WORK PROGRAM  
ARCHITECTS**

Alison Allred

FIRST PLACE

**Elizabeth River  
Project: Ryan  
Resilience Lab**

CERTIFIED SUSTAINABLE BUILDING





# BRIGHTEST IDEA

SPONSORED BY  
DAN LURIE & ASSOCIATES



# DAN LURIE ASSOCIATES



**2/90**  
Sign Systems

**MÓZ**  
Metals + Architectural  
Products

**cef**  
INNOVATE CREATE REPEAT

**PSi**  
PANEL SPECIALISTS, Inc.

**ATI**  
DECORATIVE  
LAMINATES

CELEBRATING  
**25 YEARS**  
IN BUSINESS!

















**GARC LLC**

Yang Tian & Suping Li

BRIGHTEST IDEA

# Gallery House

RESIDENCE OVER 3,500 SF



# 2025 PROGRAM SPONSORS



**Dan Lurie**  
Associates, Inc.  
Architectural and Interior Products







INTERIOR DESIGN  
EXCELLENCE  
AWARDS

*Thank you,  
Allison!*



IIDA | VIRGINIA  
WEST VIRGINIA  
chapter

# AWARDS

INTERIOR DESIGN EXCELLENCE

**IIDA**

VIRGINIA  
WEST VIRGINIA  
chapter

**2025**

AMERICAN  
SOCIETY OF  
INTERIOR  
DESIGNERS  
VIRGINIA







**Please take a few  
minutes to give us  
your feedback!**

